

# MCMINN COUNTY LIVING HERITAGE MUSEUM

Athens, Tennessee

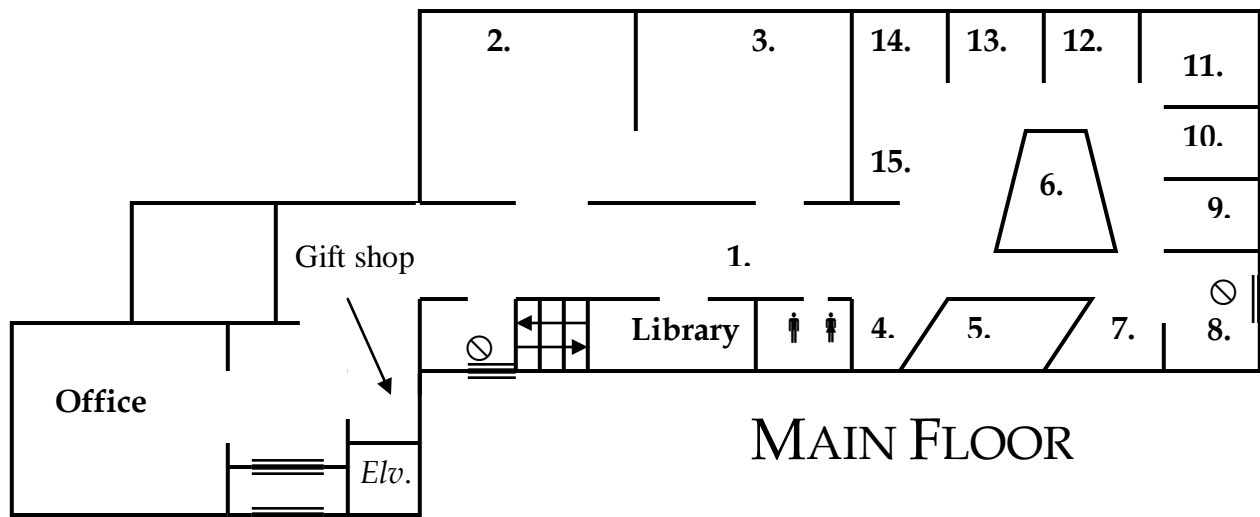

MAIN FLOOR

MAIN ENTRANCE

- |                             |                  |                       |
|-----------------------------|------------------|-----------------------|
| 1. Special Monthly Exhibits | 6. General Store | 12. Railroad          |
| 2. Parlor                   | 7. Dentistry     | 13. Sports            |
| 3. Dining Room              | 8. Attorney      | 14. Government        |
| 4. Black Heritage           | 9. Banking       | 15. America the Free  |
| 5. Rural Doctors            | 10. Print Shop   | ♂ ♀ Restroom          |
|                             | 11. Industry     | ⊗ Emergency Exit      |
|                             |                  | <i>Elev.</i> Elevator |

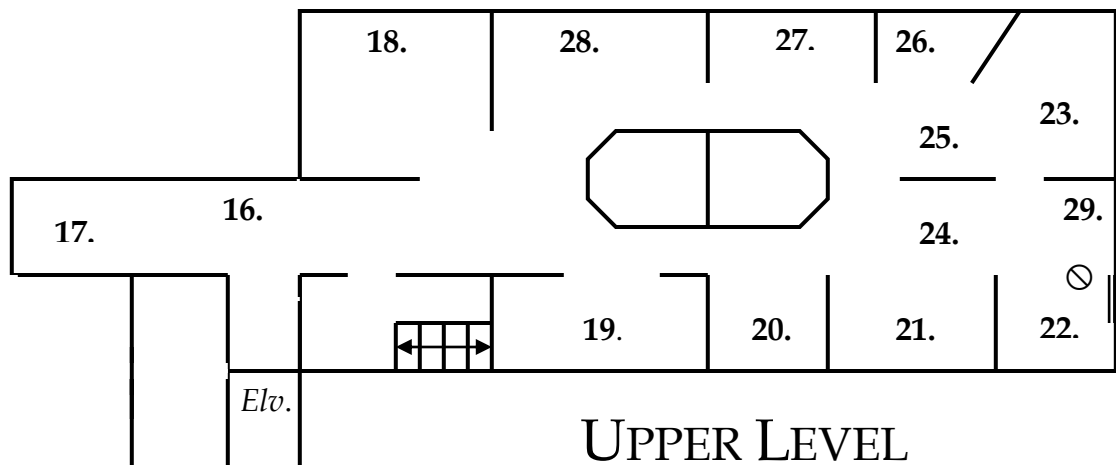

UPPER LEVEL

- |                          |                         |
|--------------------------|-------------------------|
| 16. USS Ware Exhibit     | 24. Baskets & Stoneware |
| 17. Educational Area     | 25. Carpenter Shops     |
| 18. Religion             | 26. Native Americans    |
| 19. Pioneer Cabin        | 27. Folk Art            |
| 20. One Room Schoolhouse | 28. Textiles            |
| 21. Children's Toys      | 29. Early Conveniences  |
| 22. Child's Bedroom      | ⊗ Emergency Exit        |
| 23. Agriculture          | <i>Elev.</i> Elevator   |

*Rotating Exhibits are also located on the Lower Level. Emergency Exits and Restrooms are also located there.*